

## Technical Data

Resolution:	0.01 mm (.0005")
Scale type:	ABSOLUTE electromagnetic induction linear encoder
Max. response speed:	Unlimited
Battery:	SR44 (1 pc.), <b>938882</b>
Battery life:	Approx. 3 years under normal use (1 year for models over 300 mm)

Dust/water protection level: IP67\*1 (models up to 300 mm)  
\*1 Rustproofing treatment to be applied after use.

## Optional Accessories

Code No.	Description
For 551-311-20 and 551-341-10	
264-620	U-WAVE-TC transmission unit (IP67 type)
02AZF310	U-WAVE-TC connection unit
05CZA624	SPC data cable with pushbutton (1 m)
05CZA625	SPC data cable with pushbutton (2 m)
06AFM380A	USB input tool direct USB-ITN-A (2 m)
For 551-224-10, 551-226-10 and 551-227-10	
959143	Data hold unit
959149	SPC data cable with pushbutton (1 m)
959150	SPC data cable with pushbutton (2 m)
02AZD790C	U-WAVE-T data cable with pushbutton (160 mm)
02AZE140C	U-WAVE-T data cable with pushbutton and footswitch connection (160/500 mm)
06AFM380C	USB input tool direct USB-ITN-C (2 m)

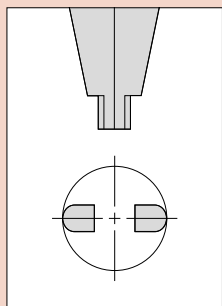

Radiused jaws for accurate ID measurement.

## SERIES 551 – ABSOLUTE Digimatic Nib/Standard Jaw Caliper

- Offers a resolution of 0.01 mm with corresponding accuracy.
- Incorporates Mitutoyo's ABSOLUTE measurement system. No need to reset the origin after switching on.
- Data output function allows integration into statistical process control and measurement systems.
- OFFSET button automatically adds the thickness of the inside jaws to the measured value so that the result can be read directly (551-311-20 and 551-341-10). Preset function enables an arbitrary reference value to be added to the measured value for comparison measurements (551-341-10).
- Tips of the outside measurement jaw are relieved for easy measurement of thin parts.

MeasurLink<sup>®</sup> ENABLED  
Data Management Software by Mitutoyo

ABSOLUTE

IP67

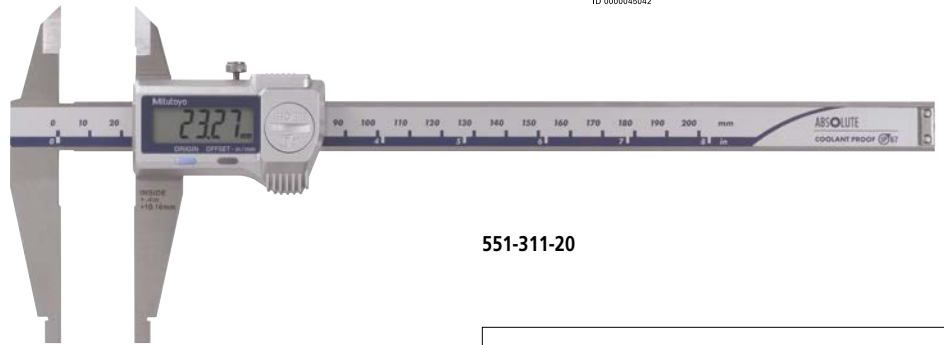

551-311-20

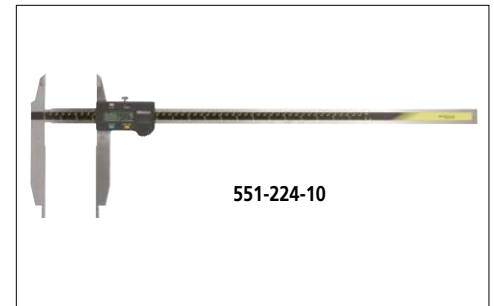

551-224-10

## Specifications

Inch/Metric

Code No.	Range*2	Accuracy*3	Remarks
551-311-20	0 - 200 mm / 0 - 8" (10 - 210 mm / .4 - 8.4")	±0.03 mm / ±.0015"	IP67
551-341-10	0 - 300 mm / 0 - 12" (10 - 310 mm / .4 - 12.4")	±0.04 mm / ±.002"	IP67, with offset/preset functions for easy inside and comparison measurement
551-224-10	0 - 500 mm / 0 - 20" (20 - 520 mm / .5 - 20.5")	±0.06 mm / ±.0025"	—
551-226-10	0 - 750 mm / 0 - 30" (20 - 770 mm / .5 - 30.5")		
551-227-10	0 - 1000 mm / 0 - 40" (20 - 1020 mm / 1 - 41")	±0.07 mm / ±.003"	

\*2 ( ): Inside measurement.

\*3 Excluding quantizing error.

Note: Series 551 is not equipped with a depth bar.

## Dimensions

Range	Unit: mm							
	A	B	C	D	E	F	t	R
0 - 200 mm	60	5	8	30	23.6	16	3	5
0 - 300 mm	90		10	40.1	32.4	20	3.8	
0 - 500 mm	150	10	15	56	44.9	25	6	10
0 - 750 mm					43.8	32	8	
0 - 1000 mm					20			

